

NYE GALA PARADE - ROAD CLOSURE

VINCENT ST + MIDLAND HWY - CATEGORY 2

GPS: -37.343070, 144.143872

ROAD CLOSURE - DETOUR SIGNAGE

- Road Closure in place 5pm - 10pm
- *Truck route marked in CYAN*
- *Parade route (2 x laps) marked in green*

Default TTM Road Categories
 Category 2 - Multilane or divided roads & High speed Highways
 Posted speed and AADT of:
 (1) A speed limit greater than, or equal to 60 Km/h and traffic volume greater than, or equal to 3000 vehicles per day AADT.
 (2) Any speed limit with traffic volumes greater than, or equal to 10000 vehicles per day AADT

Default TTM Road Categories
 Category 1 - Most urban streets and lower volume rural roads
 Posted speed and AADT of:
 (1) Any speed limit with less than 3000 vehicles per day AADT
 (2) A speed limit of less than 60km/h and traffic volumes between 3000 and 10000 vehicles per day AADT

TRAFFIC CONTROLLERS WILL BE ON SITE TO ASSIST WITH PEDESTRIAN TRAFFIC AND TRUCKS ACCESS THROUGH THE CLOSURE

AMOUNT OF TRAFFIC CONTROLLERS WILL VARY, DEPENDING ON REQUIREMENTS

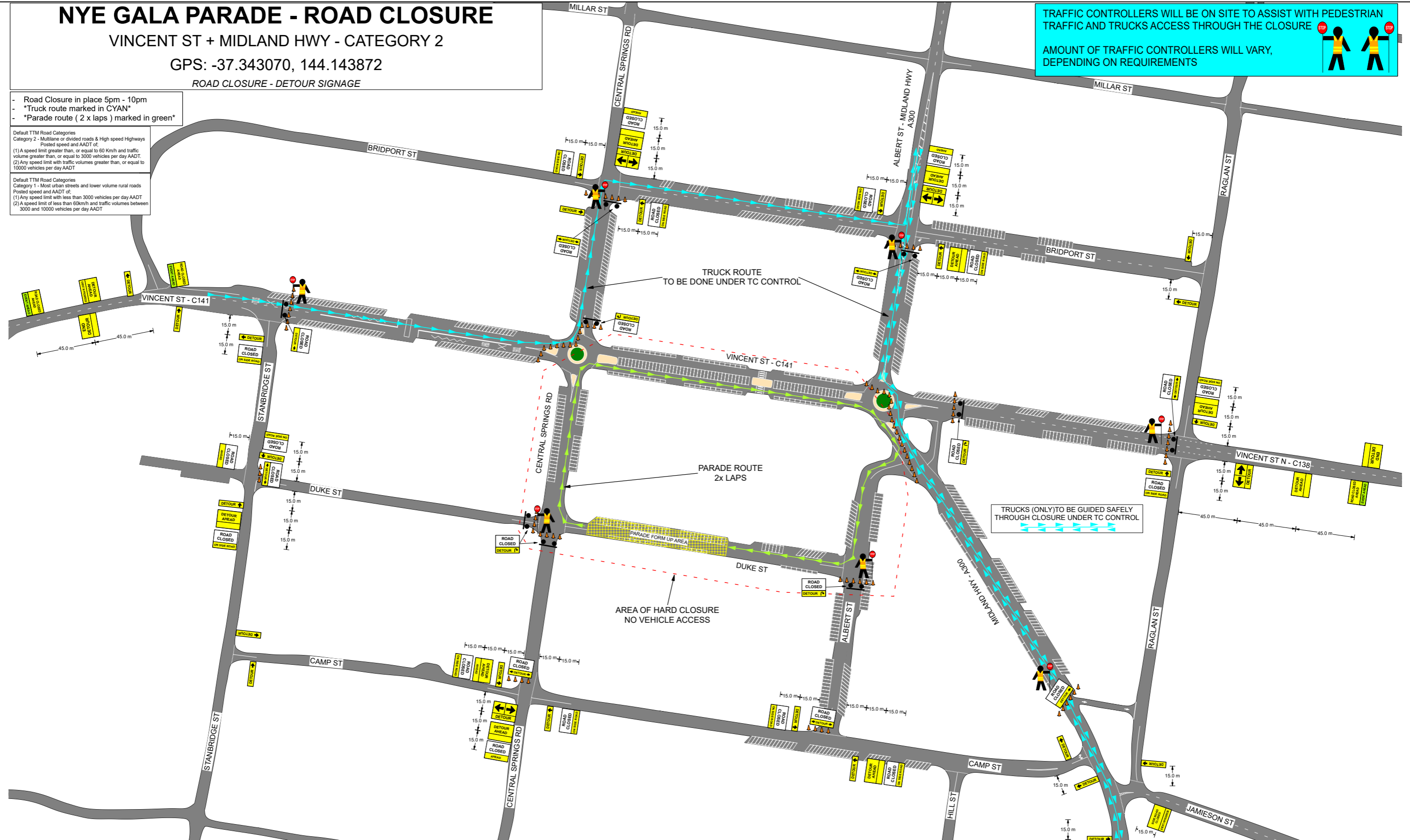
LOCATION:	VINCENT ST - C141 + C138 MIDLAND HWY - A300
SUBURB:	DAYLESFORD
MELWAYS REF:	--
VRCSD REF:	MAP 582 - E 10
MUNICIPALLY:	HEPBURN SHIRE COUNCIL
ROAD TYPE:	ARTERIAL (RED) ARTERIAL (BLACK)

AUTHOR:	PAUL HERRIOT
AUTHOR MOBILE:	0420 615 710
AUTHOR 2:	BLAKE CHAMBERLAIN
AUTHOR MOBILE 2:	0475 443 612
CLIENT:	HEPBURN SHIRE COUNCIL
SITE CONTACT:	TRACY PETRIE
CONTACT MOBILE:	--
PROJECT:	NYE GALA PARADE
EXISTING SPEED:	40KM/H + 50KM/H
REDUCED SPEED:	ROAD CLOSED
ROAD TYPE:	SEALED

NOTES AND COMMENTS:-

NYE GALA PARADE DAYLESFORD

This Traffic Guidance Scheme has been created in accordance with the Australian Standard (AS 1742.3-2019) and the Austroads Guide to Temporary Traffic Management and Worksite Safety - Traffic Management Code of practice 2023 and is not to scale. The positioning of signs, devices and lengths of tapers may be (as a minimum) 10% less than the distances given OR as a maximum, 25% more than the distances given and may need to be revised onsite to improve visibility and/or effectiveness. Barwon Traffic Management does not accept responsibility for the compliance of this plan when implemented or monitored by others. All changes to this plan must comply with the above Standard and Act and be noted in the worksite diary.

Barwon Traffic Management
0419 880 727
 For all your Traffic Management Solutions.

Plan No: BTM-NYE
Date Drawn: 06/08/2025
Version No: 1

